



National Trust *for* Historic Preservation

National Trust Tours

ABOUT THE CALEDONIAN SKY

The deluxe ship features amenities including a library, hairdresser, upper deck lounge with panoramic views, and an open-air sun deck ideal for watching the passing scenery.

ACCOUNTS ON BOARD

Upon embarkation, a shipboard account is automatically opened for your convenience with an imprint of your credit card. A “chit” system will operate for onboard purchases. Each time you make a purchase, a chit will be signed by you and the purchase amount debited to your shipboard account, which is presented for settlement at the end of the voyage. Traveler’s checks, cash, American Express, MasterCard, and VISA are the only acceptable forms of payment for your account. The British pound (£) is the standard currency on board the *Caledonian Sky*, and all credit card bills and accounts are rendered in British pounds.

BAGGAGE STORAGE

Baggage can be stored inside the wardrobe in your suite, or underneath the beds.

BAR

The bar is stocked with local and international liquors and alcohol. The ship carries a small, but varied, supply of fine wines and champagnes. During lunch and dinner service in the restaurant, house wines, beer, and soft drinks are included. For drinks you choose to order in the bar, costs will be charged to your shipboard account. If you prefer to order a different wine than the included house wine at lunch or dinner, upon request, the service staff will be happy to retain unused portions for consumption at subsequent seatings.

BRIDGE VISITS

There is a daytime open-bridge policy on the *Caledonian Sky*. However, the bridge may be closed to visitors during maneuvers in port, when anchoring, or during periods of inclement weather.

CABINS AND SERVICE

The ship has a total of 57 comfortable cabins spread over 4 decks. All passenger cabins have an ocean view with either a window or portholes. Cabins on the Bridge Deck and all cabins except 431-434 on the Promenade Deck feature glass doors that open onto a private balcony. All cabins are fully air-conditioned and heated with individual climate control and have private bathrooms with shower, toilet, wash basin, hair dryer, robes, and slippers. Molton Brown toiletries, including hand soap, shower gel, shampoo, hair conditioner, and body lotion are provided. Each cabin has two twin beds that can be reconfigured by the cabin staff to form a queen-size bed upon request. All cabins have a sitting area with two armchairs, coffee table, vanity table with large mirror and stool, two bedside tables with lamps, full-length dressing mirror, desk, and mini-refrigerator. Each cabin is equipped with an electronic safe, telephone, flat-screen television, and bottled water, which is replenished daily.

Cabins are serviced every morning by your cabin attendant. They are cleaned again in the evening when beds are turned down. If you require additional housekeeping service outside these visits, please advise the reception desk.

COMMUNICATION

The *Caledonian Sky* has two computers located in the library for your use, with internet access available on a complimentary basis throughout the cruise. In order to access a personal e-mail account on these computers, you must use a web-based account, such as Yahoo or Gmail. Wireless internet access is also available in the library, some public areas, and in passenger cabins, and can be accessed for a fee using a personal electronic device. Internet cards can be purchased at reception and are currently £12 (~US\$16) for 100 minutes of use. Details and current pricing will be announced on board. *Please note that shipboard internet connectivity can*

be very slow, disrupted, or unavailable. You may wish to seek out a café with Wi-Fi service to download emails during your free time ashore.

The ship is equipped with a satellite telephone. There is a phone in each cabin, which has access to an outside line. Calls are only possible when the satellite is visible over the horizon. Please note that you will be charged for all personal communications whether inbound or outbound, and satellite reception is expensive. Phone cards for making international calls are available for purchase at reception. Fax service is not available on board. Cabin-to-cabin calls may be made free of charge.

Detailed contact information for the *Caledonian Sky* will be included with your pre-departure mailing that will be sent approximately three weeks prior to departure.

DAILY PROGRAMS

The daily program is distributed to all cabins and posted in common areas every evening on board ship. The program provides details of the cruising schedule, lectures, shore excursions, and notes about interesting sights and other activities. Weather and other conditions may alter the day's intended program. Your tour staff will notify you of any changes to the printed schedule.

DIETARY NEEDS

Special dietary requests can be accommodated, but we must be notified at least three months prior to departure in writing on your **Personal Information Form**. The galley is equipped to prepare or serve all special dietary foods except kosher cuisine.

DINING

Breakfast, lunch, and dinner are served in the restaurant on the Castle Deck. During good weather, early risers' coffee, breakfast, lunch, and dinner may also be served on the Bridge Deck. Afternoon tea is served in the lounge on the Caledonian Deck. The restaurant accommodates all passengers in one seating. Table service is provided for all evening meals, and all of the meals will be open seating. Complimentary coffee and tea are available 24 hours a day in the lounge on the Caledonian Deck.

Menus are typically European continental fare, which is regionalized (according to where the ship is traveling) by adding hints and flavors of the local cuisine, and international specialties.

ELECTRICITY

Power on board the vessel is 110 volts, 50 hertz, with U.S.-style outlets that accommodate a flat, two-prong plug. Check the specifications of your equipment before departure and make sure you have the necessary accessories.

ELEVATOR

An elevator connects all passenger decks from the Castle Deck to the uppermost Panorama Deck, with the exception of the Zodiac platform, which is reached by a short flight of stairs, with handrail.

EXERCISE FACILITIES

A small gym is located on the Promenade Deck, and includes a treadmill, stationary bicycle, cross trainer, and free weights.

GIFT SHOP

A limited range of basic toiletries and ship's merchandise is available for purchase from the reception on board. Purchases are debited to your shipboard account.

GRATUITIES

All gratuities for onboard staff and crew are included in the cost of the trip.

HAIR DRYER

Each cabin is equipped with a hair dryer, which is kept in a drawer in the dressing table.

HAIR SALON

The ship has a hairdresser, located opposite the Gym on the Promenade Deck, providing haircuts and simple hairstyling services, as well as manicures, pedicures, and massages. Prices are available at Reception, and treatments are by appointment.

LAUNDRY

The laundry service on board can handle personal laundry and pressing. A laundry list with instructions and prices is available in each cabin. Dry cleaning is not available on board.

LIBRARY

There is a small library, located next to the Bar on the Panorama Deck, which contains a selection of magazines, books, reference materials, and games for your use.

MAIL

The reception desk offers a service of mailing letters and postcards on behalf of passengers. A flat fee of £1.10 (~US\$1.45) is charged to mail a letter or postcard without a stamp. No fee is charged to mail letters or postcards with appropriate stamps already affixed. Mail is sent when the ship is in port.

MEDICAL SERVICES

The ship's infirmary is located on the Castle Deck with a fully licensed physician on board throughout the voyage. Any applicable fees for medical services received on board are debited to your shipboard account, payable at the end of the voyage.

It is essential that persons with any medical problems or drug allergies inform us well before departure so that we may brief the ship's doctor accordingly. Please indicate these in writing on your **Personal Information Form**.

If you use a hearing aid that might be turned off at night or would otherwise require special assistance in case of an emergency, please advise the reception desk of this fact at the time of boarding.

NEWS

News channels are available on televisions in each cabin, satellite conditions permitting. In addition, a national daily news bulletin is available at Reception.

PASSPORTS

All passports are collected by the purser upon embarkation and kept in the ship's safe throughout the cruise. Passports are necessary to facilitate immigration formalities for each stop on the itinerary and will be returned at the end of the voyage.

SAFETY AT SEA

Safety at sea is a major priority aboard the *Caledonian Sky*. The ship contains the latest in firefighting equipment and fully complies with the strict provisions of the International Convention for the Safety of Life at Sea (SOLAS) and International Maritime Organization 1983 amendments. All officers are trained in emergency procedures, and regular drills are held to instruct the crew in their emergency duties. For passengers, a lifeboat drill is held upon embarkation. Attendance at this drill is mandatory. All cabins are equipped with a life jacket for each passenger.

SECURITY

The security of passengers and crew is of the utmost importance. As of December 2016, current security precautions being taken aboard the *Caledonian Sky* include the following:

- Security cards are made for all passengers and must be presented whenever embarking or disembarking the ship.
- A guard is posted on the gangway while the ship is in port.
- All items brought on the ship are inspected prior to delivery.

- Visitors must be announced prior to arrival for authorization and are required to produce identification at the port and gangway, receive a visitor’s pass and be escorted to their destination on board.
- Oncoming passengers must present their passports upon initial embarkation and may be required to pass through a metal detector.
- All luggage is screened by local port authorities.

SMOKING POLICY

Smoking is not allowed inside the ship, only outside on deck in designated areas. Please use appropriate ashtrays for cigarette butts and used matches. Never throw cigarettes or cigars over the side of the ship as these may blow back onto the ship and cause a fire.

STORAGE

Each cabin has a wardrobe area with hangers and several drawers for storing your clothing, empty suitcases, and other personal items.

SAFE

A digital combination safe, which you are encouraged to use, is provided inside the closet of each cabin. Instructions for setting your personal combination are displayed next to the safe.

WATER

The ship’s water supply provides potable water of a high standard, but passengers are asked to practice conservation at all times. Complimentary bottled water for drinking is provided in your cabin and replenished each day as needed.

ZODIACS

The *Caledonian Sky* is equipped with ten 10-passenger Zodiacs for transfers to shore when the ship is at anchor. These boats are safe, dependable, and durable and enable landing in areas that might be otherwise inaccessible for a ship of this size.

Zodiacs will be used for the excursions to Marlborough Sound and Stewart Island, when the *Caledonian Sky* anchors off-shore. Generally, these are “dry landings” and do not require you to step into, or wade through, water. However, weather, the tide, and sea conditions on these days may require a “wet landing,” when you will have to step into shallow water and walk a few steps. There is also a chance of getting water splashed on you while traveling to shore or when you are exploring the islands and inlets in Marlborough Sound. Rain gear is recommended on Zodiac excursions. There will be a safety briefing on board to explain how one should embark and disembark these boats.

SHIP STATISTICS

Built in 1991	Refurbished in 2012	
Length: 297 feet	Beam: 50 feet	
Draft: 13.7 feet	Registry: Bahamas	
Maximum cruising speed: 12.5 knots	Gross Tonnage: 4,200 tons	
Maximum Passengers: 114	Crew Nationality: International	Crew
Members: 74		

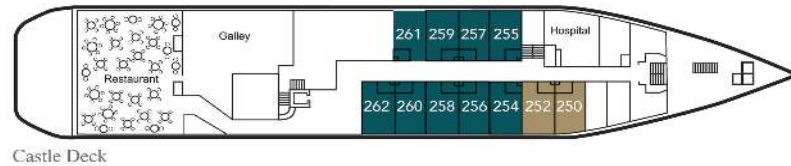
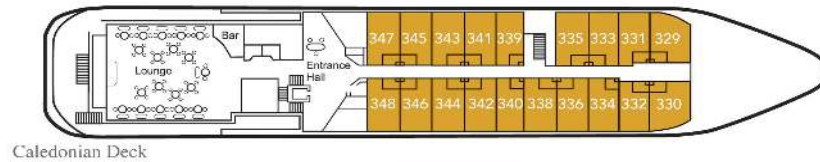
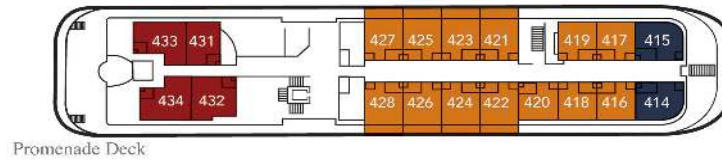
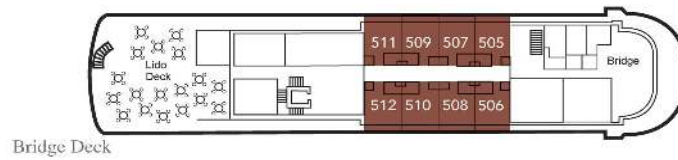
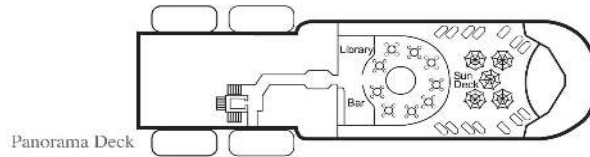
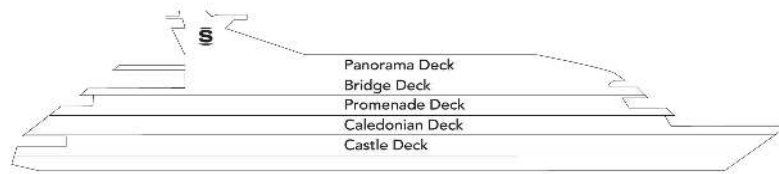

- Standard Suites (Forward)
- Premium Suites
- Premium Balcony Suites
- Standard Suites
- Corner Suites
- Superior Suites
- Deluxe Balcony Suites