



For questions or to reserve:
nationaltrusttours.orbridge.com
(866) 639-0079

Main Program: August 08, 2026 – August 15, 2026

Pre-Tour: August 06, 2026 – August 09, 2026

ICELAND AND THE COSMOS A TOTAL SOLAR ECLIPSE AT SEA



Witness the awe-inspiring path of totality during this 2026 solar eclipse luxury cruise around Iceland. This extraordinary voyage offers a front-row seat to one of nature's rarest spectacles, all while exploring Iceland's breathtaking landscapes. With world-class comfort, thrilling excursions and expert-led insights, this is a once-in-a-lifetime experience where adventure and luxury perfectly align.

NOTE: Tour information is current as of 5/19/2025.

Program Highlights

- Set off on a panoramic tour of Reykjavík prior to embarkation.
- Cruise directly along the solar eclipse's path of totality for a unique opportunity to capture this otherworldly phenomenon.
- During museum visits, gain insight into the region's maritime heritage and daily life in Iceland's rugged environment.
- Observe Iceland's iconic puffins and colonies of Arctic terns from a respectful distance with opportunities to capture delightful photographs.
- Witness the impressive geothermal activity of Europe's most powerful hot spring and experience the rejuvenating effects of the Krauma Geothermal Baths.
- On board *SH Vega*, indulge in diverse culinary specialties featuring locally sourced ingredients.
- Take advantage of the ship's amenities including the well-equipped fitness room or full service spa (*additional fees apply*).

What's Included

- 6 nights aboard exclusively chartered, luxurious *SH Vega*
- All meals: 6 breakfasts, 5 lunches and 6 dinners (served with wine, beer or non-alcoholic beverages) plus special welcome and farewell receptions
- Private tours and special small-group excursions as noted in the 8-day itinerary
- Full guiding services of a team of Orbridge Expedition Leaders and expert local guides
- Private motor coach transportation
- Luggage portage
- Gratuities to ship crew, Orbridge Expedition Leaders, local guides, drivers, porters and wait staff for included meals
- Airport transfers for guests arriving and departing during the suggested times

Itinerary



B = Breakfast, L = Lunch, D = Dinner, R = Reception

Day 1: En Route from U.S.

Saturday, August 8, 2026

Day 2: Arrive in Keflavík, Iceland | Reykjavík – Embarkation

Sunday, August 9, 2026 (R,D)

Upon arriving to Keflavík Airport an Orbridge representative will be waiting to assist with your transfer to the hospitality room in Reykjavík.

En route to the vessel, enjoy a panoramic tour of the city driving past a variety of notable landmarks including Harpa concert hall and the iconic Hallgrímskirkja church.

As embarkation begins take time to settle into your stateroom and become acquainted with the state-of-the-art *SH Vega*—your home away from home during this thrilling expedition. Elegant, well-appointed staterooms and beautifully designed public spaces offer inviting options to relax, socialize and enjoy the journey.

This evening gather with fellow travel companions for a special welcome reception and captain's gala dinner to celebrate the adventures to come.

Overnight: SH Vega

Day 3: Ísafjörður

Monday, August 10, 2026 (B,L,D)

Awake to remarkable scenery and crisp Nordic air. Gather for breakfast then disembark for Ísafjörður, a charming town nestled in the Westfjords with dramatic landscapes and a tranquil atmosphere.

Visit the Ósvör Maritime Museum for a unique glimpse into the harsh and challenging lives of Icelandic fishermen in the 19th century. The museum's centerpiece is a reconstructed 19th-century fishing station complete with a traditional turf-roofed fisherman's hut. Stepping inside the hut find yourself transported back in time to a world where Icelandic fishermen braved the cold North Atlantic waters in open rowboats. Explore Ósvör's extensive collection of fishing tools, gear and equipment that were essential to the daily lives of fishermen in the Westfjords. See old fishing nets, hand-carved wooden oars, harpoons and traditional clothing made of sheepskin and wool, plus various navigational tools that illustrate the evolution of maritime technology in Iceland over generations.

Continue to the peaceful village of Bildudalur. This small community, known for its diverse avian wildlife, was once a bustling fishing and trading hub. The town is also a gateway to our next destination—Dynjandi waterfall, whose name translates to *thunderous*. Surrounded by rugged cliffs, lush green moss and basalt rock formations this majestic setting is a perfect backdrop for photographers and nature lovers. A short hike brings you to the base of the waterfall. Along the way encounter several smaller waterfalls that are part of the main water system, together forming a cumulative height of approximately 328 feet.

After lunch visit the Ísafjörður Museum, also known as the Westfjords Heritage Museum, a captivating cultural and historical center housed in a meticulously preserved 18th-century building that was once a storehouse for the Danish trading company. Gain a fascinating glimpse into the maritime heritage and daily life of the Westfjords throughout history.

This evening enjoy live entertainment in the stylish main lounge.

Overnight: SH Vega

Day 4: Flatey

Tuesday, August 11, 2026 (B,L,D)

After breakfast board a tender destined for Flatey for a self-guided walk to see the island's bird colonies. Approaching the rugged coastline the sounds of crashing waves and distinct calls of seabirds fill the air. Prepare for close encounters (at a respectable distance) with countless puffins and Arctic terns.

Puffins, with their distinctive black and white plumage and colorful beaks, are one of Iceland's most iconic birds. The sight of hundreds of puffins perched on the cliffs or waddling around is nothing short of magical. These adorably charming birds are curious and relatively tolerant of humans, allowing for fantastic photo opportunities.

Arctic terns are renowned for their incredible migratory journeys. Unlike puffins, terns prefer flat, open areas for nesting. These birds travel thousands of miles from their wintering grounds in Antarctica to breed in Iceland, making them the ultimate globetrotters of the avian world.

Following a delicious lunch on the ship there will be an option to return to Flatey to capture final photos. Alternatively remain on board to soak in the fresh sea air from comfortable loungers on the sun deck or take a dip in the heated pool.

Late afternoon enjoy a relaxing cruise towards Grundarfjörður. Perhaps sit in on a presentation discussing the science and significance of solar eclipses, learning about the phases of the eclipse and what to expect during tomorrow's event.

Overnight: SH Vega

Day 5: Eclipse Day | Sailing the Path of Totality

Wednesday, August 12, 2026 (B,L,D)

As the ship is positioned strategically along the path of totality for unobstructed views of the sky, anticipation builds for today's celestial event. The captain and crew will provide updates on the eclipse's progress, and solar viewing glasses will be distributed.

As the moon fully covers the sun, the sky darkens and temperatures drop. The sun's corona, a stunning halo of light, creates an ethereal and otherworldly spectacle. Embrace this moment, and experience the profound sense of wonder and connection to the cosmos.

Afterward reflect on your experience with fellow travel companions.

(NOTE: Eclipse viewing is entirely weather-dependent.)

Overnight: SH Vega

Day 6: Stykkishólmur | Snæfellsnes Peninsula

Thursday, August 13, 2026 (B,L,D)

This morning visit Stykkishólmur, a picturesque town on the Snæfellsnes Peninsula renowned for its stunning views and bountiful waters. Embark on an exciting boat ride through pristine Breidafjörður Bay where you'll partake in an unforgettable Icelandic sushi tasting experience. Savor the freshest flavors as you sample an array of scallops, sea urchins and other freshly caught shellfish straight from the sea—truly an unparalleled culinary adventure.

Return to the ship for lunch then depart for an afternoon excursion to the Snæfellsnes Peninsula, whose iconic Snæfellsjökull Glacier provided inspiration for Jules Verne's *Journey to the Center of the Earth*. Explore lava fields and visit the black sand beaches of Djúpalónssandur. The peninsula also features unique geological formations including the striking basalt columns at the fishing village, Arnarstapi.

Tonight prepare for another gourmet dinner featuring fresh, locally sourced ingredients.

Overnight: SH Vega

Day 7: Akranes | Deildartunguhver | Reykjavík

Friday, August 14, 2026 (B,L,R,D)

Today's highlight features a visit to the Krauma Geothermal Baths with time to relax and rejuvenate amongst its five hot baths, cold plunge, infrared sauna, steam room and relaxation room. Fed by the Deildartunguhver hot spring, the most powerful in Europe, Krauma offers an unforgettable thermal bathing experience. Boiling water from the hot spring is carefully mixed with ice-cold water from the nearby Ok Glacier creating the perfect temperature for soaking.

Return to the ship for lunch and enjoy the afternoon sailing toward Reykjavík.

Tonight gather for a lively farewell reception followed by a convivial gala dinner to commemorate this epic journey.

Overnight: SH Vega

Day 8: Reykjavík – Disembarkation | Keflavík | Depart for U.S.

Saturday, August 15, 2026 (B)

After breakfast guests departing during the suggested times will take a complimentary transfer to the airport for flights home.

(Itinerary subject to change.)

Activity Level: 3

Moderate

Tour days tend to be long, flow at a consistent pace and may include long periods of travel. Guests should be prepared to walk longer distances, climb stairs and tolerate periods of standing, for example on city walks, sightseeing stops or excursions, on sometimes uneven surfaces including cobblestones or unpaved pathways and trails. Some destinations may have variations in altitude and/or temperature. Daily pace and timing may vary significantly between longer and shorter travel days, with additional activities possibly occurring in the early morning or evening. Guests are expected to board transportation without assistance. Elevators are not always available at accommodations or sites visited.

Your Guide(s)

Orbridge Expedition Leader Team



Our premier team of Orbridge Expedition Leaders will accompany you throughout this journey. Each leader is highly trained and offers a wealth of knowledge and experience as a guide.

Enriched by their insight and enthusiasm, enjoy the cultures and locations you explore with added confidence, understanding and appreciation.

Kevin McKeegan — Special Faculty Host



Kevin McKeegan is a Distinguished Professor Emeritus and former Chair of UCLA's Department of Earth, Planetary, and Space Sciences. As a Cosmo chemist, McKeegan studies the compositions of solar system materials to better understand its origin and evolution. His research includes samples from asteroids, comets, ancient Earth and Mars, as well as the Moon and even the Sun. The Moon and Sun play a significant role in his recent work, especially in light of the upcoming solar eclipse on August 12, 2026. During this event, the Moon will perfectly block the Sun's light, creating a moment in time that no observer will ever forget. This will mark McKeegan's second solar eclipse, and he is eager to experience the path of totality once more. It will also be his second visit to Iceland, one of the most captivating places on Earth. This promises to be an unforgettable journey to the land of fire and ice, where sunlight and shadow will meet in a spectacular display.

Accommodations

SH Vega



August 9 - August 14

Embark on an unparalleled journey of luxury and elegance aboard the *SH Vega*. From the moment you step on board, you'll be enveloped in an atmosphere of opulence and comfort.

Refined staterooms, each featuring ocean views, offer a serene retreat after the day's adventures. Inviting common spaces foster a sense of warm camaraderie among fellow travelers.

Indulge in gourmet dining that elevates every meal to an extraordinary culinary experience. The ship offers several dining venues to cater to different tastes and preferences.

The observation lounge offers floor-to-ceiling windows providing stunning panoramic views of the surrounding landscapes.

Stateroom Amenities: Snacks, stocked minibar with soft drinks and beer, Illy Espresso coffee machine with coffee pods, tea kettle and Kusmi tea bags, complimentary Wi-Fi (subject to satellite reception), TV service, bathrobes and slippers, towels for cabin, swimming pool and gym, premium Lajatica sundries (hand soap, shower gel, shampoo, conditioner and body lotion), and hair dryer.

Oceanview (Deck 4) approx. 215 sq.ft.

One double or two single beds, living room area, private bathroom, and flame-effect fireplace.

Balcony (Deck 5, 6) approx. 269 sq.ft. with balcony approx. 54 sq. ft.

One double or two single beds, living room area, private bathroom, flame-effect fireplace, and private balcony.

Suite (Deck 5, 6) approx. 430 sq.ft. with balcony approx. 108 sq. ft.

King bed, living room, large private bathroom with separate bathtub and walk-in shower, flame-effect fireplace, and private balcony.

Premium Suite (Deck 6) approx. 505 sq.ft. with balcony approx. 129 sq. ft.

King bed, walk-in wardrobe, living room, large private bathroom with separate bathtub and walk-in shower, flame-effect fireplace, and private balcony.

SH Vega DECK PLAN

STATEROOMS

- D4 Oceanview
- M4 Oceanview
- D5 Balcony
- M5 Balcony
- D6 Balcony
- Suite
- Premium Suite

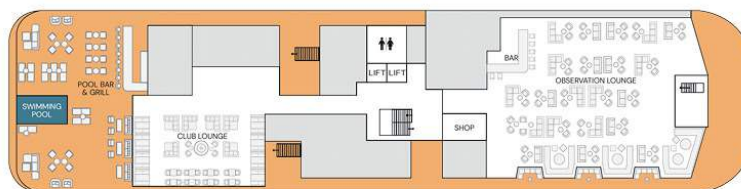

DECK 8: Gym,
Sauna, Jacuzzi,
Spa, Bridge

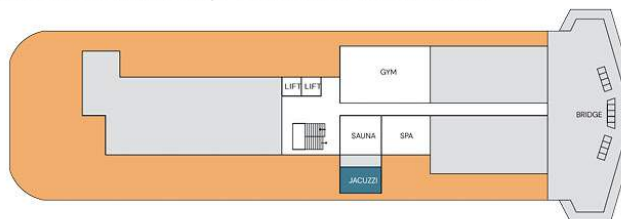

DECK 9:
Stargazing Deck

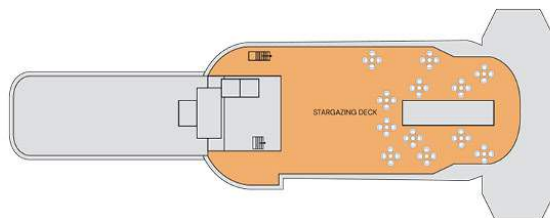

(Accommodations subject to change.)

Optional Pre-Tour

REYKJAVÍK



Begin your adventure in Iceland's vibrant capital city rich with timeless traditions, intriguing history and colorful culture. Discover the area's Viking and maritime heritage during museum visits, and immerse yourself in the tranquil geothermal waters of the area's iconic lagoons.

Itinerary

B = Breakfast, L = Lunch

Day +1: En Route from U.S.

Thursday, August 6, 2026

Day +2: Arrive in Keflavík, Iceland | Reykjavík

Friday, August 7, 2026

Upon arriving to Keflavík International Airport transfer to the Blue Lagoon for a unique geothermal spa experience.

The Blue Lagoon is a man-made spa that harnesses geothermal activity from deep within the earth. This otherworldly oasis of milky-blue waters enveloped in a blanket of warm steam is surrounded by rugged black lava rock terrain creating a surreal science fiction-like backdrop.

During your soak in the mineral-rich waters, make sure to visit a swim-up station for a complimentary silica mud mask—an indulgent treatment that cleanses and revitalizes the skin.

Continue to Hallgrímskirkja, one of Iceland's most iconic landmarks, for an inside visit. This towering Lutheran church is renowned for its unique architectural design, which was inspired by Iceland's basalt lava flows. Marvel at the magnificent pipe organ, designed by the German organ builder Johannes Klais, standing 49 feet tall with an impressive 5,275 pipes.

Late afternoon, check into the hotel and enjoy the remainder of the day at leisure.

Overnight: Iceland Parliament Hotel

Day +3: Reykjavík

Saturday, August 8, 2026 (B)

After breakfast at the hotel meet a local guide for a comprehensive panoramic city tour.

Then venture inside Perlan, a natural history museum with exhibits showcasing Iceland's natural phenomena including volcanoes, earthquakes and geothermal energy. Walking through the Glacier Exhibition—a man-made cave designed using more than 350 tons of snow and ice—feel the chilly atmosphere while gaining insight into the formation, history and future of Iceland's glaciers. Stop into the 360° Planetarium Show to witness the breathtaking beauty of the Northern Lights. And visit Perlan's observation deck for vast views over Reykjavík's skyline.

Continue to the National Museum of Iceland, a treasure trove of artifacts and exhibits that chronicle Iceland's rich and complex history from the Viking Age to modern times. The museum provides a comprehensive look at how Icelandic society has evolved over the centuries, providing an enlightening journey through time.

Conclude touring with an inside visit to Harpa, Reykjavík's stunning glass concert hall and cultural center. Designed by Danish firm Henning Larsen Architects in collaboration with Icelandic artist Ólafur Eliásson, Harpa's exterior is made of thousands of glass panels arranged in a honeycomb pattern that reflect the sky and water. The resulting kaleidoscope of colors change with the weather and time of day. The interior itself is a work of art, with geometric patterns and sweeping views of the sea.

Enjoy the afternoon and evening at leisure to explore independently.

Overnight: Iceland Parliament Hotel

Day +4: Reykjavík | Golden Circle | Main Program Begins

Sunday, August 9, 2026 (B,L)

Following breakfast and check-out depart for a full-day Golden Circle excursion. This scenic route takes you through some of the country's most iconic natural and historical landmarks including Þingvellir National Park, Geysir Geothermal Area and Gullfoss Waterfall.

Þingvellir, a UNESCO World Heritage Site, holds a special place in Icelandic history as the location of the Althing, one of the world's oldest parliaments—established in AD 930. Also geologically significant, it lies in a rift valley between the North American and Eurasian tectonic plates, meaning visitors can literally walk between continents.

Next stop by Fridheimar Farm for lunch. This family-owned farm actively operated by a husband and wife team plus their five children grows tomatoes and cucumbers all year round in geothermally-powered greenhouses.

Continue to Geysir Geothermal Area—home to Strokkur, one of the world's most famous active geysers that erupts every 5–10 minutes. Although the area's original namesake, Geysir, is now mostly dormant, it's still an impressive geothermal landscape with steaming hot springs, bubbling mud pots and mineral-rich pools.

Gullfoss (or Golden Falls) is one of Iceland's most breathtaking waterfalls with two cascading tiers dropping into a deep canyon. The waterfall was named due to the golden hue that sometimes appears in its mist, particularly when sunlight shines through. The powerful flow of water, sourced from the Hvítá River, plunges nearly 105 feet in a spectacular display. Enjoy various perspectives of the falls from several viewing platforms—each a prime spot for incredible photos and an awe-inspiring reminder of Iceland's raw natural beauty.

Late today return to Reykjavík to join guests arriving for the main program.

Pre-tour space is limited. We recommend reserving early for best availability.

(Itinerary subject to change.)

Activity Level: 3

Moderate

Tour days tend to be long, flow at a consistent pace and may include long periods of travel. Guests should be prepared to walk longer distances, climb stairs and tolerate periods of standing, for example on city walks, sightseeing stops or excursions, on sometimes uneven surfaces including cobblestones or unpaved pathways and trails. Some destinations may have variations in altitude and/or temperature. Daily pace and timing may vary significantly between longer and shorter travel days, with additional activities possibly occurring in the early morning or evening. Guests are expected to board transportation without assistance. Elevators are not always available at accommodations or sites visited.

Accommodations

Iceland Parliament Hotel



August 7 - August 8

Enjoy first-class comforts and amenities at this ideally situated hotel located within a few minutes walk of Reykjavík's highlights.

Room Amenities: Individual climate control, complimentary Wi-Fi, LCD TV, coffee maker, safe, mini fridge, bathrobes and slippers, iron and ironing board, and en suite bathroom with sundries and hair dryer.

(Accommodations subject to change.)

What's Included

- 2 nights hotel accommodations
- 2 breakfasts and 1 lunch
- Guided city and Golden Circle touring
- Entrance fees to Perlan Museum, National Museum and Harpa concert hall
- Luggage portage
- Guiding services of an Orbridge Travel Director
- Gratuities to Orbridge Travel Director, local guide, driver and porters
- Airport transfers for guests departing during the suggested times

Terms and Conditions

THE FOLLOWING TERMS AND CONDITIONS ARE EFFECTIVE AS OF FEBRUARY 28, 2025.

Note: Travel credits and transfers are subject to the Terms and Conditions agreed upon at the time of the original reservation.

ORBRIDGE® TERMS AND CONDITIONS, RELEASE AND BINDING ARBITRATION AGREEMENT

For **Orbridge Private Jet Tours** Terms and Conditions, [click here](#).

This Agreement includes contractual terms and conditions and releases Orbridge, LLC from liability. Any payment to Orbridge, including but not limited to deposits or full payments, constitutes your acknowledgement of, and agreement to, this Terms and Conditions, Release and Binding Arbitration Agreement Orbridge set forth below and in subsequent tour documents.

Limitation of Responsibility. Orbridge LLC, its shareholders, directors, officers, employees and affiliates (collectively, "Orbridge"), does not own or operate any entity that provides goods or services for your trip including, for example, ownership or control over hotels or other lodging facilities, airline, vessel, bus, van or other transportation companies, local ground operators, providers or organizers of optional excursions or equipment used thereon, food service or entertainment providers, etc., even if they use the "Orbridge LLC" or "Orbridge" name. All such persons and entities are independent contractors. As a result, Orbridge is not liable for any negligent or willful act or failure to act of any such person or entity, or of any other third party. Without limitation, Orbridge is not responsible for any injury, loss, or damage to person or property, death, delay or inconvenience (collectively, "losses") in connection with the provision of any goods or services occasioned by or resulting from, but not limited to, acts of God, acts of government, force majeure, acts of war or civil unrest, insurrection or revolt, strikes or other labor activities, criminal or terrorist activities of any kind, or the threat thereof, overbooking or downgrading of accommodations, structural or other defective conditions in hotels or other lodging or vessel facilities, mechanical or other failure of airplanes or other means of transportation or for any failure of any transportation mechanism to arrive or depart timely or safely, dangers associated with or bites from animals, pests or insects, marine life or vegetation of any sort, dangers incident to recreational activities such as scuba diving, snorkeling, paddle boarding, surfing, swimming, kayaking, sailing, canoeing, rafting, hiking, bicycling, rock climbing, etc., sanitation problems, food poisoning, lack of access to or quality of medical care, difficulty in evacuation in case of a medical or other emergency, illness, epidemics, pandemics or the threat thereof or for any other cause beyond the direct control of Orbridge. In addition, I release Orbridge from its own negligence and assume all risk thereof.

Rates. Program rates are based on minimum participation levels, current fares and costs (air, water, land, rail), tariffs and currency values. While Orbridge does everything possible to maintain the listed program rates, they are subject to change effective immediately upon posting unless otherwise specified by Orbridge. In the case of invoicing errors, we reserve the right to re-invoice with the correct pricing.

Reservations, Deposits and Final Payment. To secure your reservation, deposits are due upon placing a reservation as follows: (1) \$850 per person per program and \$500 per person per pre-tour and/or post-tour except for programs noted in (2) and (3); (2) \$2,500 per person for Antarctica Discovery, African Expedition by Private Train and 2026 Iceland and the Cosmos: A Total Solar Eclipse at Sea and \$500 per person per pre-tour and/or post-tour; (3) a non-refundable \$750 per person is due for Tanzania Wildlife Safari's Rwanda pre-tour. Orbridge accepts payment by check, automated clearing house ("ACH"), wire transfer or major credit card.

Final payment, including any pre-tour and/or post-tour, optional excursion(s) fees and optional electives, is due for: (1) all programs except Antarctica Discovery, African Expedition by Private Train and all 2026 Total Solar Eclipse Tours—no later than 90 days prior to the program's scheduled departure date; (2) Antarctica Discovery, African Expedition by Private Train and all 2026 Total Solar Eclipse Tours—no later than 195 days prior to the program's scheduled departure date.

If your reservation is made between the final payment due date and the program's scheduled departure date, the full cost of the program, plus any pre-tour and/or post-tour, optional excursion(s) fees and optional electives, is due at the time of registration.

If final payment is not received by Orbridge by the final payment due date, Orbridge may, at any time and with or without notice, cancel your reservation in its sole discretion with no right of refund.

Reservation Grace Period. Reservations made no sooner than 120 days prior to all programs' scheduled departure date, except Antarctica Discovery, African Expedition by Private Train and all 2026 Total Solar Eclipse Tours, and no sooner than 225 days prior to Antarctica Discovery's, African Expedition by Private Train's and all 2026 Total Solar Eclipse Tours' departure date may be cancelled within 30 days following the reservation date ("Grace Period") for a full refund.

All payments made for Tanzania Wildlife Safari's Rwanda pre-tour are non-transferrable and non-refundable.

Notice of termination must be received by Orbridge during the Grace Period and provided in writing either via email or mailed letter. The date of receipt will be used for the effective date.

Reservation Changes. Reservation changes (including, but not limited to, name changes) are subject to availability and cannot be guaranteed. Reservation changes will not incur an administration fee except in the following cases: 1) Reservation changes completed 90 or fewer days from the program's scheduled departure date for all programs except Antarctica Discovery, African Expedition by Private Train and all 2026 Total Solar Eclipse Tours will incur a \$150 administrative fee plus any third-party penalties and/or charges. 2) Reservation changes completed 195 or fewer days from the program's scheduled departure date for Antarctica Discovery, African Expedition by Private Train and all 2026 Total Solar Eclipse Tours will incur a \$150 administrative fee plus any third-party penalties and/or charges. In addition, any reservation changed from double occupancy to single occupancy will be charged the single occupancy rate, which will be due at the time of final payment or upon receipt of an updated invoice if received after the tour's final payment due date.

Reservation Cancellation and Refunds. Notice of cancellation must be submitted to Orbridge in writing either via email or mailed letter. The date of receipt will be used for the effective date and the cancellation will be processed as follows:

(a) For all programs except those noted in (b) and (c), if the cancellation notice is received by Orbridge more than 90 days prior to the program's scheduled departure date, all monies paid to Orbridge for the main program and for any pre-tour and/or post-tour will be refunded less an administrative fee of \$350 per person for the main program and \$200 per person for a pre-tour and/or post-tour. If the cancellation notice is received by Orbridge between 90 and 76 days prior to the scheduled departure date, a 25% cancellation fee will be applied to the full cost of the program, including any pre-tour and/or post-tour, optional excursion(s) fees and optional electives, and the balance will be refunded. If the cancellation notice is received by Orbridge between 75 and 61 days prior to the scheduled departure date, a 50% cancellation fee will be applied to the full cost of the program, including any pre-tour and/or post-tour, optional excursion(s) fees and optional electives, and the balance will be refunded. If the cancellation notice is received by Orbridge between 60 and 46 days prior to the scheduled departure date, a 75% cancellation fee will be applied to the full cost of the program, including any pre-tour and/or post-tour, optional excursion(s) fees and optional electives, and the balance will be refunded. If the cancellation notice is received by Orbridge within 45 days prior to the scheduled departure date, a 100% cancellation fee will be applied to the full cost of the program, including any pre-tour and/or post-tour, optional excursion(s) fees and optional electives.

(b) For Antarctica Discovery, African Expedition by Private Train and 2026 Iceland and the Cosmos: A Total Solar Eclipse at Sea, if the cancellation notice is received by Orbridge more than 195 days prior to the scheduled departure date, all monies paid to Orbridge for the main program and for any pre-tour and/or post-tour will be refunded less an administrative fee of \$950 per person for the main program and \$200 per person for a pre-tour and/or post-tour. For Castile and the Cosmos: Total Solar Eclipse in the Heart of Spain and Catalonia and the Cosmos: Total Solar Eclipse on the Spanish Coast, if the cancellation notice is received by Orbridge more than 195 days prior to the scheduled departure date, all monies paid to Orbridge for the main program and for any pre-tour and/or post-tour will be refunded less an administrative fee of \$350 per person for the main program and \$200 per person for a pre-tour and/or post-tour. If the cancellation notice for Antarctica Discovery, African Expedition by Private Train and all 2026 Total Solar Eclipse Tours is received by Orbridge between 195 and 150 days prior to the scheduled departure date, a 25% cancellation fee will be applied to the full cost of the program, including any pre-tour and/or post-tour, optional excursion(s) fees and optional electives, and the balance will be refunded. If the cancellation notice is received by Orbridge between 149 and 120 days prior to the scheduled departure date, a 50% cancellation fee will be applied to the full cost of the program, including any pre-tour and/or post-tour, optional excursion(s) fees and optional electives, and the balance will be refunded. If the cancellation notice is received by Orbridge within 119 days prior to the scheduled departure date, a 100% cancellation fee will be applied to the full cost of the program, including any pre-tour and/or post-tour, optional excursion(s) fees and optional electives.

(c) All payments made for Tanzania Wildlife Safari's Rwanda pre-tour are non-refundable.

A 100% cancellation fee applies to all non-refundable airfare. Refunds, if any, will be processed within 30 days of our receipt of your written notice.

Travel Insurance. Orbridge strongly recommends that you purchase travel and cancellation insurance to protect your investment in the event of unexpected or unforeseen circumstances. In addition, we recommend that you consider obtaining a policy(ies) that will cover emergency medical evacuation insurance and cancel for any reason insurance. Travel and cancellation insurance policies and dates by which policies must be purchased vary by provider/insurer, maximum coverage (including cancel for any reason) is generally only available for purchase within 14 days of your reservation being confirmed. It is advised to determine your insurance needs and make necessary arrangements soon after reserving on tour. If you do not have, but are interested in purchasing, travel and cancellation insurance please contact us.

Program Cancellations or Postponements. All programs are subject to cancellation or postponement by Orbridge prior to the scheduled departure date for reasons such as, but not limited to, insufficient participation, or logistical problems that, in Orbridge's sole judgment, may impede program operations or represent conditions or events that may expose program guests and/or Orbridge to undue risk of harm, injury, damage or inconvenience. In the event of program cancellation or postponement by Orbridge, Orbridge may offer you alternative arrangements such as the option to join the same tour on a different date or a different tour. If the price of your alternative booking is lower than your original booking price, Orbridge will refund the difference within 30 days of the alternative program's departure date. If it is higher than your original booking price, Orbridge will invoice you the difference and you will be responsible therefor. Transferred guests are subject to the terms of the original tour. Except for force majeure, if a program is cancelled or postponed by Orbridge, Orbridge will refund all payments made within 30 days of notice of program cancellation or postponement if an alternative arrangement is not offered.

Itineraries. Accommodations, the itinerary, travel directors or expedition leaders, lecturers, hosts, faculty or organization representative, and arranged excursions are subject to change or substitution at any time due to unforeseen circumstances or circumstances beyond Orbridge's control. Reasonable efforts will be made to operate programs as planned, however adjustments, substitutions and changes may occur after the final itinerary has been issued. Orbridge may, in its sole discretion, withdraw a program or any part of it, make such alterations or substitutions to the itinerary or program inclusions as it deems necessary or desirable, and pass on to program participants any expenditures or additional costs caused by any such adjustments, or by delays or events beyond its reasonable control.

Not Included. Unless otherwise specifically noted in the itinerary, program prices do not include the following expenses, which if applicable are your sole responsibility to pay and satisfy: trip cancellation insurance and passenger travel protection plan; domestic, international, and internal airfares except as indicated in program inclusions; transfers and luggage handling fees except in connection with scheduled group flights; costs associated with obtaining passports or entry visas; airport departure taxes; airline ticketing fees; airport transfers when arriving/departing on other than scheduled group dates; excess baggage charges; any new value added taxes or other taxes added to program costs by applicable governmental authorities; gratuities to drivers, guides, or ship's crew not specified; meals and beverages other than those specified as being included in the itinerary; sightseeing not included in the itinerary; personal expenses such as laundry, communication charges and optional activities (which are subject to availability); ship, air, or transportation fuel surcharges, if applicable; any items not on the "included" list of the tour documents.

Health and Fitness to Travel. Through your participation in your tour, you assume responsibility for your own health, safety, and welfare and acknowledge that Orbridge cannot absolutely guarantee your safety or health. Your physician can provide guidance on your personal health risk and precautions to take while traveling. Some programs include physically active elements. To enjoy these programs as intended, a minimum level of fitness is required and Orbridge will require all guests to follow local, state, national and/or World Health Organization health and safety mandates. Accordingly, you must be in good physical and mental condition to participate. You represent that you have no physical, mental or other condition, impairment or disability that may or will cause or create a risk of injury or other hazard to yourself or others in respect to any aspect of the program you have selected. Orbridge may, in its sole discretion, limit, restrict or prohibit from participation in any aspect of any program any individual that it considers in its sole discretion to be impaired or unsuitable due to fitness level. In addition, Orbridge may, in its sole discretion and at the participant's sole expense, remove the guest from the program, or restrict the program-related activities of any individual whose physical or mental condition may or is likely to cause a hazard to himself/herself or others, or otherwise impair the enjoyment of other program participants. Any physical condition requiring special attention, diet, or treatment must be reported in writing to Orbridge at the time a program reservation is made. Should you have any questions or need any clarification about a specific program, please ask for details at the time of registration. Orbridge will try to accommodate your situation if possible.

Accessibility. Orbridge cannot guarantee that the transportation, lodging, and entertainment/sightseeing accommodations will be accessible to all persons regardless of their physical and mental condition. In addition, many of the activities involved in each program include walking or the like for some distance on uneven ground or pavement or moving water as well as the ability to walk up and down stairs without assistance. Should any individuals seeking to participate in a travel opportunity need special accommodations to ensure their enjoyment of the trip, kindly provide notice at the time the reservation is submitted, and we will see if your participation is feasible. Please understand that the Americans with Disabilities Act is inapplicable outside the United States.

At the time of reservation, Orbridge needs to be notified to determine if the special needs of an individual traveler can be met through special arrangements. It is possible that minor modifications to the services can be provided, but only if Orbridge is made specifically aware of anticipated needs. This notification should be made in writing no less than two weeks prior to the planned travel. Neither Orbridge nor any of the providers of transportation, lodging, or other services can provide special accommodations without this advance notice.

Where an individual with certain specific needs will be traveling with a group, it is necessary for other members of that person's group to be available to assist as necessary. Neither employees of Orbridge nor any suppliers of services can allow any of their employees to provide physical assistance to any guests.

Travel Advisories. The State Department and the Centers for Disease Control periodically issue statements and advisories about risks to travelers. These statements are country specific and contain important information. The State Department information can be found at www.travel.state.gov, and the CDC statements can be found at www.cdc.gov. Orbridge highly recommends everyone to review these sites.

Children. Orbridge welcomes the participation of children in most of its programs. However, in the event you do include your children or other minors for whom you serve as legal guardian ("Dependents") in your travel plans, you hereby agree that you are and shall be at all times solely responsible for their care, actions, safety and protection during the program and any pre-tour and/or post-tour. Should you have any questions whether a particular program or inclusion is possible or suitable for your Dependent(s), please contact us.

Baggage. Program rates include the price of one piece of policy-compliant baggage per person during the land, cruise or rail portion of the program only unless specified in the itinerary. Air carriers and motor coaches often impose significant other restrictions or limitations on the number of pieces, size and weight of luggage and may reject or impose additional fees on luggage exceeding such limitations or restrictions. All such fees are your sole cost and responsibility. In addition and regardless of location or transportation method, your baggage and personal effects are and shall at all times be at your sole risk throughout the entire program. Please check with your air carrier for other applicable baggage restrictions and limitations.

Travel Documents. All guests are responsible for possessing and maintaining necessary travel documents. These documents shall be valid under state and federal law and as required by foreign countries being visited. Orbridge is not responsible for invalid travel documents and repercussions thereof.

For U.S. citizens, valid passports are required for travel to foreign destinations and some countries require specific visas prior to entry. Please direct any questions in respect to visa requirements to Orbridge, which shall use commercially reasonable efforts to provide answers as a courtesy, provided that it shall remain your sole responsibility and obligation to obtain and verify that you have all required travel documents, including visas, necessary and appropriate for the program location(s) and sufficient blank pages in your passport for visas and immigration stamps. In addition, some countries require your passport to have an expiry date of not less than six months after your anticipated return to the United States. Orbridge disclaims all liability for any expenses or costs you may incur due to your prohibition or restriction from entering a country on the program itinerary or reentering the United States at the conclusion of the program. If travel documents fail to meet these requirements, boarding of aircraft or ship to any international destination may be denied and entry into such countries may be denied.

Photos and Videos. Orbridge may take photographs and/or video of its trips and participant grants Orbridge permission to do so and for it to use such for promotional or commercial use without payment of any compensation to participant. In addition, Orbridge may use, without compensation, any photographs or video taken by tour participants and submitted to Orbridge or to SmugMug without payment of any compensation. In submitting any such photographs or videos to Orbridge or SmugMug, participant warrants that he or she took the image and that the dissemination of same does not violate the copyright rights of any person.

Data Rights, Permissions. Data collected and/or derived by Orbridge resulting from your use of the Website is the sole and exclusive property of Orbridge and may be used in any manner consistent with its Privacy Policy located on Orbridge's website. By submitting to Orbridge a digital or hard copy form that includes your personal contact information, including without limitation, your email address and telephone number(s), you give Orbridge and any other entity identified on the form permission to use that information to contact you and as otherwise may be described on the form and/or in the Privacy Policy.

Other. Dates, program details and costs are based on tariffs, exchange rates and other information current at the time of printing, but are subject to change at any time. While we do not anticipate material revisions of the itinerary or its included features, we do reserve the right to substitute accommodations or modes of transportation and to make any changes in the itinerary Orbridge, in its sole discretion, deems necessary and in that case any additional expense or cost will be paid by the individual guest. Your baggage and personal effects are your sole responsibility at all times. It is prohibited by federal law and Orbridge policy to bring illegal drugs, firearms, or other contraband (including marijuana for medical or recreational purposes) on any program.

Orbridge may at any time and without notice modify these terms and conditions, and any modification so made will be effective for all reservations made from and after the posted Effective Date.

In the event any term in these terms and conditions is deemed unenforceable the unenforceable clause shall be interpreted to give effect to the parties' intentions to the greatest enforceable extent, and all other provisions hereof shall remain fully enforceable according to their terms.

Individual Supplier Contracts. Individual contracts/terms from Orbridge's contracted suppliers govern the relationship between that supplier and the Orbridge guest. These respective contracts/terms often establish limits on liability, limits on claims, define the time to file claims, the acceptable jurisdictions for making claims, etc. They should be reviewed with care.

Click any of the following for links to:

[Alaskan Dream Cruises](#) (Discover Southeast Alaska)

[Albatros Expeditions](#) (Antarctica Discovery)

[Amadeus River Cruises](#) (Flavors of Provence River Cruise, Cruise the Danube By Luxury River Ship)

[Lazy Bear Lodge](#) (Polar Bears of Churchill, Polar Bears & Beluga Whales)

[Metropolitan Touring](#) (The Galapagos Islands)

[Ponant](#) (Northern Adriatic: A Nautical Voyage, Cruise the Majestic Nordic Fjords, The Greek Isles by Luxury Sailing Yacht, Aegean Sea Odyssey: The Greek Isles & Historic Türkiye)

[Teton Science Schools](#) (Wolves & Wildlife of Yellowstone)

Registering for a tour and submission of payment to Orbridge acknowledges guests' acceptance of the above contracts/terms for relevant suppliers. In addition, guests may be asked to sign an acknowledgement of these or other individual supplier's terms upon arrival on tour as a condition of participation.

Binding Arbitration. I agree that any dispute concerning, relating, or referring to this contract, the brochure, or any other literature concerning my trip, or the trip itself shall be resolved exclusively by binding arbitration in Seattle, Washington, either according to the then existing commercial rules of the American Arbitration Association or pursuant to the Comprehensive Arbitration Rules & Procedures of the Judicial Arbitration and Mediation Services, Inc. (JAMS). Such proceedings will be governed by substantive (but not procedural) Washington law. The arbitrator and not any federal, state, or local court or agency shall have exclusive authority to resolve any dispute relating to the interpretation, applicability, enforceability, conscionability, or formation of this contract, including but not limited to any claim that all or any part of this contract is void or voidable. By agreeing to these terms and conditions, both parties are waiving their right to a trial by jury. Any arbitration commenced against Orbridge must be on behalf of only the individual(s) to this Agreement and his or her immediate family members traveling with them, such as a spouse or child. Under no circumstances can participant be part of a class or other joint action.

Acceptance of Contract. ANY PAYMENT TO ORBRIDGE, INCLUDING BUT NOT LIMITED TO DEPOSITS OR FULL PAYMENTS, CONSTITUTES YOUR ACKNOWLEDGEMENT OF AND AGREEMENT TO THESE TERMS AND CONDITIONS SET FORTH ABOVE AND IN MORE SPECIFIC TOUR DOCUMENTS.

©2025 ORBRIDGE LLC. All rights reserved.

ORBRIDGE, ORBRIDGE DESTINATION SPECIALISTS, ORBRIDGE GROUP, and OBR are service marks of Orbridge LLC. The service marks and trademarks of any supplier appearing in these materials are owned by each respective company.

WAST# 602828994; CAST# 2098750-40

(v. 022825)