



National Trust *for* Historic Preservation

National Trust Tours

Baja California: Among the Great Whales

Aboard *National Geographic Venture*

January 16-23, 2027

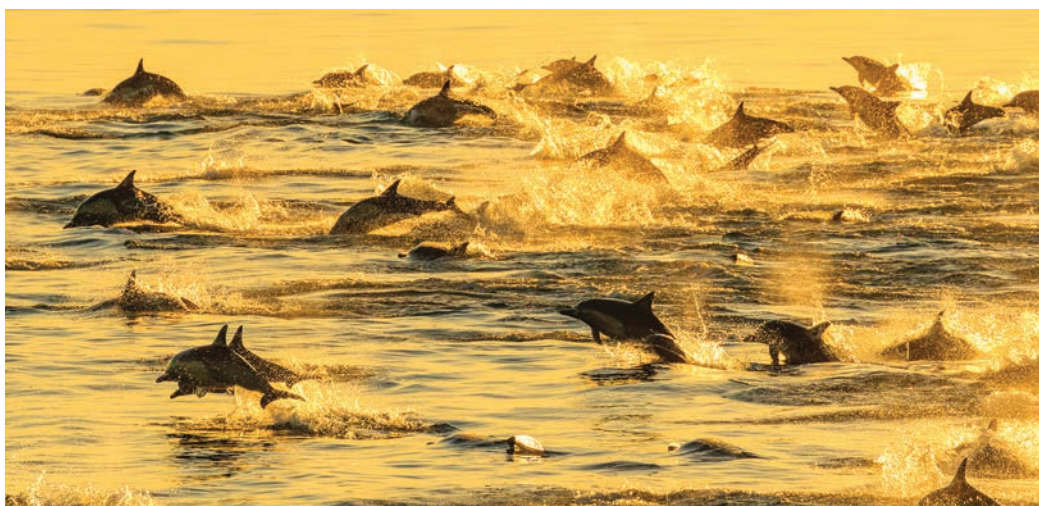

Baja California: Among the Great Whales



Expedition Highlights

Explore Baja California's pristine coastlines and living sea in search of dolphins, sea lions and as many as five different varieties of whales. Board local pangas and enter sheltered lagoons for up-close encounters with California gray whale mothers and their newborn calves. Witness an undersea wonderland, serene desert isles and the most beautiful sunsets on Earth. Hike through towering cacti and up striking desert canyons or take a slow photo stroll along the shore. Every day is different and rewarding, with opportunities to indulge in active or relaxing pursuits.

- ✓ Enter gray whale birthing lagoons for up-close encounters with gray whale mother-calf pairs.
- ✓ Embark on regular marine safaris in search of dolphins, sea lions and up to five species of whales.
- ✓ Snorkel amidst the vibrant sea life, including curious sea lions at Los Islotes.
- ✓ Hike desert isles, including Espiritu Santo Archipelago National Park, and witness the variety of flora and fauna thriving in this region.
- ✓ Spot myriad bird species including diving pelicans, magnificent frigatebirds and brown and blue-footed boobies.
- ✓ With National Geographic Explorers-in-Training, our exclusive family program, kids and teens will learn about this vibrant part of the world—from migrating gray whales to desert plant species.

Itinerary

DAY 1

LORETO, MEXICO/EMBARK

Arrive in Loreto in early afternoon and transfer to *National Geographic Venture* to set sail at sunset. (D)

Opt for a one-night pre-voyage extension in Loreto to relax and explore this picturesque gulfside town dotted with Spanish colonial architecture.

DAY 2

BAHÍA CONCEPCIÓN

Awake in Bahía Concepción, and take your coffee to the deck to witness the colorful landscapes revealed by the first of many gorgeous sunrises. This biodiversity hotspot is ripe for exploration. Board Zodiacs in search of whales and other marine life, kayak through lush mangrove systems and snorkel in turquoise waters. On land, join an invigorating hike among towering cacti, or stroll the pristine beaches and learn about the ecology from the naturalists. (B,L,D)



DAY 3

EXPLORING THE GULF OF CALIFORNIA

The Gulf of California is home to great biological diversity, and with some luck, sightings of whales, dolphins and other sea life are among the highlights of your journey. The plan is flexible as guests explore some of the uninhabited islands sprinkled across these waters. Conditions permitting, you may hike, kayak or paddleboard. Learn about this ecosystem from a naturalist and capture amazing photos with help from your certified photo instructor. (B,L,D)

DAY 4

BOCA DE SOLEDAD

After breakfast, transfer by motorcoach from Puerto Escondido to Puerto López Mateos. Settle in for unforgettable experiences in this tranquil lagoon. Together with savvy local fisherman, you'll venture out in pangas to view the numerous mother-calf pairs. With luck, enjoy up-close interactions with these curious creatures. Enjoy lunch at a traditional restaurant before returning to the ship in late afternoon. (B,L,D)

DAYS 5-7

CABO PULMO/LOS ISLOTES/GULF OF CALIFORNIA

Venture south to discover the gems of the southern Gulf. These islands and surrounding waters are celebrated for their conservation stories, marine life and the many thrilling experiences on offer. Some of the locations you may visit or enjoy by Zodiac include:



CABO PULMO NATIONAL MARINE PARK

Set out to snorkel the pristine reefs of Cabo Pulmo National Marine Park, one of the most successful national marine parks in the world. Chat with locals about their advocacy to protect this unique place, including a cessation of fishing to protect the reef.

ISLA ESPÍRITU SANTO

A national park as well as UNESCO World Heritage site with volcanic rock formations, scenic beaches and coral reefs. This magical island offers excellent hiking opportunities and crystal-clear waters for snorkeling. It's a popular destination for researchers monitoring sea turtles.

LOS ISLOTES

Located at the northern tip of the UNESCO Biosphere Reserve, Los Islotes is largely inaccessible to people and home to a large colony of sea lions. Conditions permitting, the ship will anchor off the rocky island where you don flippers, a mask, and snorkel (provided) and swim with these curious inhabitants.

ISLA SAN JOSÉ

One of the larger islands in the Gulf of California, San José offers several landing possibilities depending on conditions and the whim of the moment. Photograph the ochre cliffs of the island's eastern shore, hike an enchanted, cactus-laden arroyo or visit the abandoned salt works to the west. Discover rare wildlife among desert islands. (B,L,D)

DAY 8

DAY 8: LORETO/DISEMBARK

After breakfast, disembark the ship and transfer to the Loreto airport for flights home. (B)

LORETO PRE-VOYAGE EXTENSION

Arrive early for a relaxing and educational pre-voyage stay in the charming, seaside town of Loreto, Mexico, the first colonial settlement in Baja California. Visit the Jesuit-founded Misión San Francisco Javier de Viggé-Biaundó and learn about the rich history of the mission and the surrounding area. Enjoy time to explore Loreto on your own and experience the culture and cuisine of this tranquil town.



National Geographic Venture

CAPACITY: 50 cabins accommodating 100 guests.

REGISTRY: United States. **OVERALL LENGTH:** 238 feet.

PUBLIC AREAS: Global gallery; fitness center; LEXspa; lounge with full service bar and facilities for films and presentations; observation deck; mudroom with lockers for expedition gear, and a partially covered sundeck with chairs and tables. The open Bridge provides guests an opportunity to meet the officers and captain and learn about navigation.

MEALS: Served in single seatings with unassigned tables for an informal atmosphere. Cuisine is fresh, sustainable, accented with regional flair and served plated.

CABINS: All cabins face outside with windows or portholes, private facilities and climate controls. Category 4 cabins have step-out balconies.

EXPEDITION EQUIPMENT: A fleet of 8 Zodiacs and 24 kayaks, stand-up paddleboards, ROV (remotely operated vehicle); hydrophone, splash-cam, underwater video camera and video microscope.

SPECIAL FEATURES: Guest Wi-Fi access, elevator, National Geographic certified photo instructor, undersea specialist and a medical professional.

WELLNESS: The vessel is staffed by a wellness specialist and features a gym with an elliptical machine, treadmill, exercycles, hand weights and resistance bands. Massages in the LEXspa are available by appointment.

LINDBLAD EXPEDITIONS—PIONEERING RESPONSIBLE EXPLORATION: From our consistent quest to improve our practices to offsetting 100% of our carbon emissions, supporting conservation, science and education initiatives around the planet and investing in the communities conservation, science and education initiatives in the places we explore, we are guided by our commitment to explore responsibly.

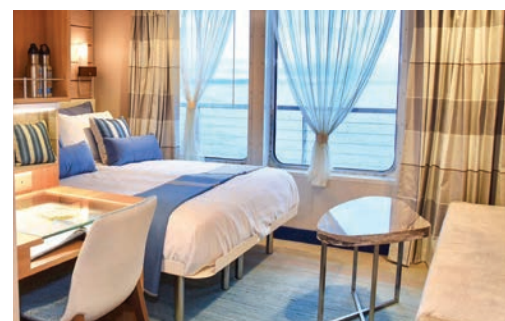

National Geographic Venture

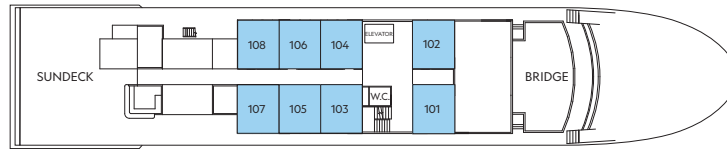

OBSERVATION DECK

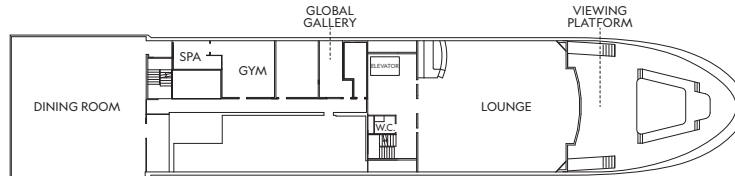

LOUNGE DECK



UPPER DECK



MAIN DECK

CATEGORY 1

Main Deck #301-306
Cabins feature two single beds that can convert to a queen, a writing desk and two portholes.

CATEGORY 2

Main Deck #307-315
Cabins feature two single beds that can convert to a queen, a writing desk and two portholes.

CATEGORY 3

Upper Deck #201-206
Cabins feature two single beds that can convert to a queen, a writing desk and two large view windows.

CATEGORY 4

Upper Deck #207-229
Cabins feature two single beds that can convert to a queen, a writing desk, sliding glass door and small, private balcony.

CATEGORY 5

Observation Deck #101-108
Cabins feature two single beds that can convert to a queen, large view windows, an expanded bathroom, writing desk, ample storage space and a convertible sofa bed to accommodate a third person.

NOTE: Solo Occupancy cabins are available in Categories 1 and 2 only. Third person rates are available in Category 5 cabins at one half the double occupancy rate.

Connecting Cabins via internal doorway access: Main Deck: #312-314, #311-315, #306-308, #305-307; Upper Deck: #224-226, #225-227

Shared Accommodations: Shares can be arranged at the double occupancy rate in Categories 1 and 2.

Baja California: Among the Great Whales

VOYAGE DATES	CAT. 1	CAT. 2	CAT. 3	CAT. 4	CAT. 5	CAT. 1 SOLO	CAT. 2 SOLO	ADVANCE PAYMENT
January 16-23, 2027	\$6,173	\$6,555	\$7,011	\$8,417	\$9,263	\$9,192	\$9,833	15% of the cabin fare, per person

Terms and Conditions

PRICING: Prices quoted in this flyer are per person based on double occupancy in USD. Prices shown are subject to change and availability at time of booking. Under normal conditions the total expedition price is guaranteed at the time advanced payment is made. However, our expedition pricing is determined far in advance of initial departure on the basis of then-existing projections of fuel and other costs. In the event of increases in those costs, including but not limited to increases in the price of fuel, currency fluctuations, increases in government taxes or levies or increased security costs, we reserve the right to adjust the price of your expedition or add a surcharge to cover such unexpected increases. We will always provide an explanation of the reason for increase in costs.

COST INCLUDES: Accommodations aboard ship; all meals as indicated in the itinerary, beer, wine, cocktails and spirits with premium wines and liquors available for purchase; all shore excursions, sightseeing, special access permits and entrance fees; transfers to/from airport if traveling within recommended arrival and departure windows; morning stretch classes and access to the fitness center; access to the OM System Photo Gear Locker; 24-hour access to the lounge, observation decks, library and other shared spaces; complimentary reusable water bottle; gratuities to local guides; basic Wi-Fi with the option to upgrade; services of Lindblad Expeditions' natural history staff, National Geographic certified photo instructor, medical professional and local guides; port taxes and service charges. Unused services or items included in this program are non-refundable.

NOT INCLUDED: Airfare; meals not indicated; extensions; passport, visa and immigration fees; travel protection plan; gratuities to the ship's crew; items of a personal nature such as certain premium brands of wines and liquors, spa treatments, enhanced and premium Wi-Fi plans and laundry.

AIRFARE: Airfare is an additional cost. Lindblad Expeditions will gladly assist in making your air arrangements for a \$50 per person service fee.

RESERVATIONS: To confirm your place, an advance payment of 15% per person is payable by Visa, MasterCard, American Express, Discover or check. Receipt of advance payment indicates your acceptance of the terms and conditions.

FINAL PAYMENT: Due no later than 120 days prior to departure. Lindblad Expeditions reserves the right to cancel your reservation if payment has not been received by final payment due date.

TRAVEL PROTECTION PLAN: National Trust Tours strongly recommends the purchase of trip cancellation insurance, which is available for coverage of expenses in conjunction with cancellation

due to covered illness or accident. In the event that you must cancel your participation in a travel program, trip cancellation insurance may be the only source of reimbursement. USI Travel Insurance Services offers a plan designed specifically for National Trust Tours travelers, providing coverage for Trip Cancellation, Trip Interruption, Travel Delay, Baggage Delay, Baggage Loss, Emergency Medical and more. Plus, you can upgrade your plan with Cancel For Any Reason (CFAR) coverage for the utmost flexibility. CFAR allows you to cancel your trip for ANY reason at all and be reimbursed up to 75% of your pre-paid, non-refundable trip costs (conditions apply, see plan for details). For additional information, please contact National Trust Tours at (888) 484-8785.

ITINERARY MODIFICATIONS: Itineraries, routing and speakers listed are correct at time of publication, and are subject to change.

ENTRY AND VISA REQUIREMENTS: Guests are advised to verify travel documents (passport/transit visa/entry visa) for the country(s) through which they are transiting and/or entering. Reliable and most current information regarding international travel can be found by contacting the consulate/embassy of the country(s) you are visiting or transiting through. We will not be responsible if you are denied entry or transit into a country if you are unable to provide valid documents as per the country's requirement.

RESPONSIBILITY AND OTHER TERMS & CONDITIONS: Certain other provisions concerning, among other things, limitations of Lindblad Expeditions' and National Geographic Expeditions' (a division of National Geographic Partners, LLC) liability for loss of property, injury, illness, or death during the voyage will be provided to all guests on the ship's ticket sent prior to departure or upon request. By registering for a trip, the guest agrees to all such terms and conditions.

CANCELLATION FEE POLICY (PER PERSON)

120 or more days prior to expedition start: **No penalty:** Advance Payment will be credited toward your next expedition**

119-90 days prior to expedition start: **50% of trip cost*****

89-0 days prior to expedition start: **100% of trip cost*****

**Advance payments will be credited in the form of a Lindblad Expeditions Travel Certificate, valid for 12 months from the date of cancellation, and which may only be applied towards final payment on any future booking.

***Trip cost is total price paid including extensions, charter airfare and other additional services.

We strongly recommend that you purchase a travel protection plan.

Photo Credits: Ralph Lee Hopkins, Michael S. Nolan, Alberto Montaudon Ferrer and Marc Cappelletti.

RESERVATION FORM



National Trust for Historic Preservation
National Trust Tours

Baja California: Among the Great Whales

To register, please contact:
National Trust Tours
Ph: (888) 484.8785
Email: info@nationaltrusttours.com

Aboard *National Geographic Venture*
January 16-23, 2027

Passenger Information

Please reserve _____ place(s).

Guest 1: _____
(As it appears on passport)

Date of Birth: _____ M/F: _____

Email: _____

Primary Phone: _____ Cell Phone: _____

Guest 2: _____
(As it appears on passport)

Date of Birth: _____ M/F: _____

Email: _____

Primary Phone: _____ Cell Phone: _____

Street Address: _____

City: _____ State: _____ ZIP: _____

Accommodations: Double Single Twin share with a friend
 Share with roommate assigned by tour operator.

Please indicate choice of cabin category in order of preference:

1st choice: _____ 2nd choice: _____

Please send me information on the **Loreto** pre-voyage extension.

Advance Payment Information: 15% of the cabin fare, per person.

If paying by credit card, we will contact you to finalize your booking and collect
payment _____

information.